

MINI-CROSKILL ROLPAF 410

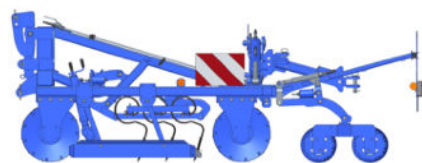

DOUBLE ROTO-HARROW Ø300

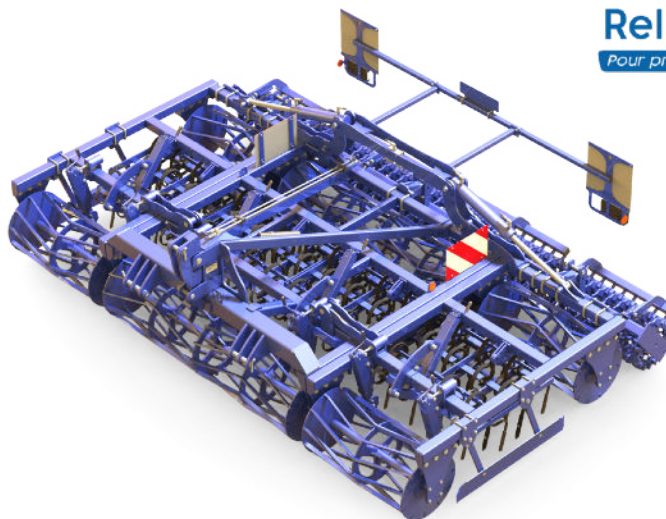

COMDOR P

COMDOR P combines a succession of tool trains, giving it perfect technical expertise for creating seedbeds in a single pass - an important condition for rapid emergence, but also a guarantee of profitability.

BENEFITS

- . 3 point floating and ROLNEC 500/11 rollers for optimum levelling and tracking of worked ground.
- . Optional hydraulically adjustable levelling board for increased flow.
- . Precise parallelogram adjustment of working depth.
- . Mini croskill rolpaf 410 with integral elements mounted floating for perfect consolidation of the seedbed and calibration of clods.
- . High protection 40 mm bearings.

Description

COMDOR P is characterised by its short length, but also by its ability to work efficiently on all types of soil. It is recommended for preparation work on small plots and for medium-power tractors. COMDOR P can be fitted with two types of tines and finishings that can be quickly removed for preliminary work. Exceptional levelling and easy-to-operate adjustment of active components, homogeneous seedbed with no dry areas and stable depth. Optimum compaction with very good referencing for high-precision seeding, enabling fast, regular emergence. Double the productivity of an animated tool. Highly versatile and modular thanks to the different types of tines available.



COMDOR MOUNTED (27x10 teeth)		3000 P Fixed	3500 P Fixed	4000 PR Fixed	4000 PH Folding	5000 PH Folding
DOUBLE ROTO-HARROW Ø 300	PRICE (€ EX.T) Reference	CO10180	CO101850	CO10183	CO10184	CO10188
MINI-CROSKILL ROLPAF 410	PRICE (€ EX.T) Reference	CO10185	CO101855	CO10186	CO10187	CO10200
OPTIONS	Equipment Tines 32X12 12 tines/M on 3 rows (extra)	CO10700	CO107005	CO10701	CO10701	CO10702
	Equipment Hydraulic levelling board (extra)	CO10380P	CO103805P	CO103808P	CO10381P	CO10382P
	Lighting kit (All models)	PRICE (€ EX.T) Reference	CO10390	rear hitch		CO10308
	Set of 8 track eradicating ploughshares (For 27x10 teeth)	PRICE (€ EX.T) Reference	CO10395	Hydraulic rear outlet D.E		CO10307
	Safety track eradicator teeth (pair) Only on COMDOR 4000 and 5000 PH	PRICE (€ EX.T) Reference	CO10398	Hydraulic output D.E coupled to folding		CO10371

* EX.T : Excl Tax

Active organs

ROLNEC roll Ø 500mm
 8 bars with 10 mm thick flange

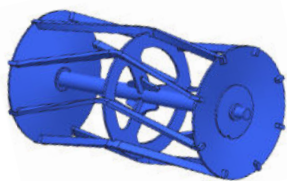

27x10 flexible tooth
 Straight with share



ROTO-HERSE Ø 300mm roller
 9 bars with 10 mm thick flange

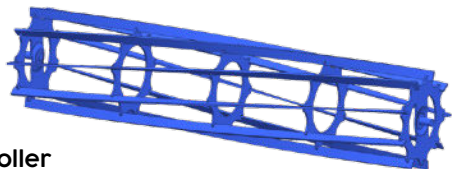

Disk ROLPAF



32x12 flexible tooth
 with crow's foot or straight ploughshare

Technical information

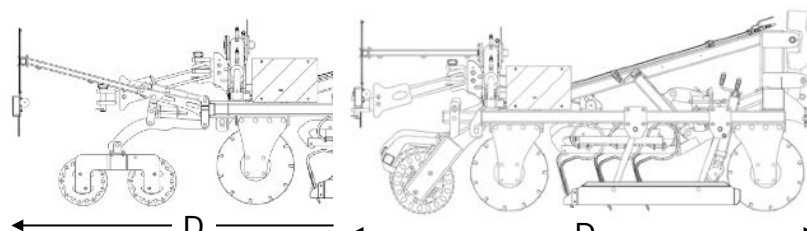
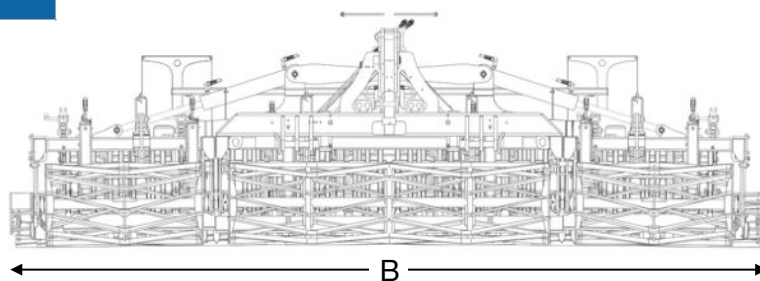
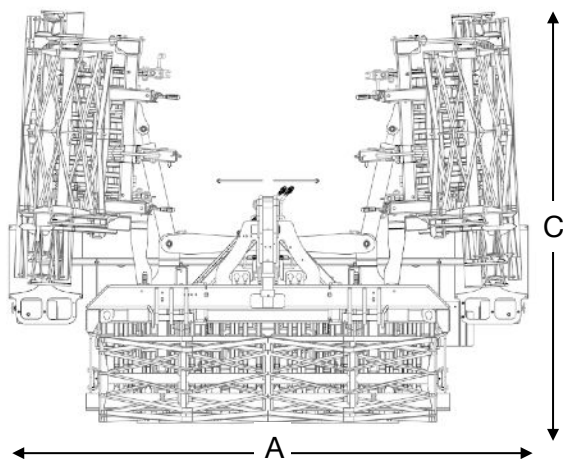

DOUBLE ROTO-HARROW Ø 300

MINI-CROSKILL ROLPAF 410

COMDOR MOUNTED (27x10 teeth) DOUBLE ROTO-HARROW Ø 300

Model	Effective working width	Overall width, folded (A)	Overall unfolded width (B)	Chassis type	Max height on support leg (C)	Depth with signalling (D)	Weight of complete machine (Kg)	Number of teeth Mounting VIBREX 27x10 / VIBREX 32x12	HP power Minimum
3000 P	3,00 m	3,10 m	3,10 m	Fixed	1,31 m	3,50 m	1500	48/36	100
3500 P	3,50 m	3,90 m	3,90 m	Fixed	1,31 m	3,50 m	1960	56/42	120
4000 PR	4,00 m	4,50 m	4,50 m	Fixed	1,31 m	3,50 m	2360	64/48	130
4000 PH	4,00 m	3,00 m	4,50 m	Folding	2,35 m	3,50 m	2680	64/48	130
5000 PH	5,00 m	3,00 m	5,50 m	Folding	2,90 m	3,50 m	2950	80/60	180

COMDOR MOUNTED (27x10 teeth) MINI-CROSKILL ROLPAF 410

3000 P	3,00 m	3,00 m	3,00 m	Fixed	1,31 m	3,00 m	1980	48/36	160
3500 P	3,50 m	3,80 m	3,80 m	Fixed	1,31 m	3,00 m	2520	56/42	170
4000 PR	4,00 m	4,40 m	4,40 m	Fixed	1,31 m	3,00 m	3080	64/48	180
4000 PH	4,00 m	3,00 m	4,40 m	Folding	2,35 m	3,00 m	3620	64/48	180
5000 PH	5,00 m	3,00 m	5,30 m	Folding	2,90 m	3,00 m	3940	80/60	210